

Padlock 802-2 Oval B25 / B60 / B110

EN 12320 Grade 3



- An all-purpose padlock for tool boxes, lockers, trailers, power station switches.
- 50 mm solid chrome plated brass padlock.
- Stainless steel shackle. Shackle dia 8 mm.
- For use with Oval cylinder.
- Double locking hardened stainless steel ball bearing.
- Spring loaded shackle.
- The padlock is also available as self locking and weather protected versions.



Certified by SBSC in Sweden
Certificate No 14-206

Padlock 802-2 Snowman B25 / B60 / B110

EN 12320 Grade 3



- An all-purpose padlock for tool boxes, lockers, trailers, power station switches.
- 46 mm solid chrome plated brass padlock.
- Stainless shackle. Shackle dia 8 mm.
- For use with "snowman" cylinder.
- Double locking hardened stainless steel ball bearing.
- Spring loaded shackle.
- The padlock is also available as self locking version.



Certified by SBSC in Sweden
Certificate No 04-598

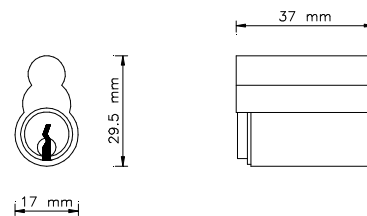
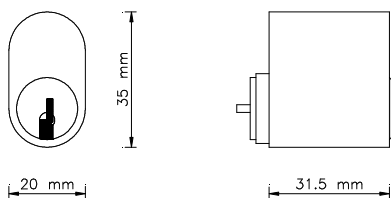

The ANCHOR LÅS High Security Padlock 840-4, 834-4 830-3 and 802-2 are made for use with oval cylinder.

The ANCHOR LÅS High Security Padlock 840-4 and 802-2 are made for use with "snowman" cylinder.

Model Number	EN Grade	SSFN-014 Class	Body					Shackle					Keying	
			Material	Finish	Thickness mm (F)	Thickness mm (E)	Height mm (D)	Material	Finish	Diameter mm (B)	Clearance mm (A)	Clearance mm (C)	Oval cylinder	"Snowman" cylinder
840-4	5	4	HS	CH	30	80	65	HS	CH	15	27	40	●	●
840-4 B50	5	4	HS	CH	30	80	65	HS	CH	15	50	40	●	●
834-4	4	3	HS	CH	25	60	94	HS	CH	11	28	28	●	
830-3	4	3	HS	CH	25	60	62	HS	CH	11	28	28	●	
830-3 B50	4	3	HS	CH	25	60	62	HS	CH	11	50	28	●	
802-2 Oval	3	2	BR	CH	25	50	62	SS	-	8	25	24	●	
802-2 Oval B60	3	2	BR	CH	25	50	62	SS	-	8	60	24	●	
802-2 Oval B110	3	2	BR	CH	25	50	62	SS	-	8	110	24	●	
802-2	3	2	BR	CH	20	46	61	SS	-	8	25	24		●
802-2 B60	3	2	BR	CH	20	46	61	SS	-	8	60	24		●
802-2 B110	3	2	BR	CH	20	46	61	SS	-	8	110	24		●

HS = case hardened steel SS = stainless steel BR = brass CH = chrome plated

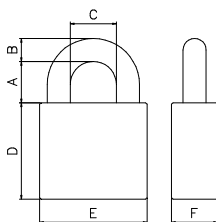

SECURITY GRADE EUROPEAN STANDARD EN 12320

Requirements	1	2	3	4	5	6	
Corrosion, salt spray (time)		24	24	96	96	96	h
Key retained in open position	no	no	no	yes	yes	yes	
Minimum number of differs	300	1 000	2 500	5 000	10 000	20 000	
Non-interpassing of keys with just one interval differ – Torque on key	1	1	1,5	1,5	1,5	1,5	Nm
Load on cylinder plug or locking mechanism			4	5	10	15	kN
Torque resistance of cylinder plug		2,5	5	15	20	30	Nm
Pulling of shackle/staple	3	5	15	30	70	100	kN
Twisting of shackle/staple	40	100	200	450	1 200	2 500	Nm
Cutting of shackle/staple	6	15	25	35	70	100	kN
Blow on lock body and shackle/staple (weight/g x height/mm)			1 250 x 800	3 050 x 1 000	6 550 x 1 400	7 150 x 1 500	x 5
Test temperature			-20°C	-20°C	-40°C	-40°C	
Drilling				2	4	8	min
Sawing				2	4	8	min

SWEDISH PADLOCK CLASS STANDARD SSFN014

Extra tests SSF padlock standard	1	2	3	4	5	
Lock picking and tampering	2 simple tools	2 simple tools	10 composite tools	10 composite tools	30 advanced tools	min
Attack with manual tools			5	10	15	min